

THE WESTPORT at Hobbs Hole



Elevation C

Shown with optional: side-entry garage, extended front porch



Elevation A



Elevation B

Shown with optional: garage door w/ glass



9245 Shady Grove Rd., Suite 200
Mechanicsville, VA 23116
www.rcibuildersnewhomes.com

Elevations shown are artist's rendering. All plans, details, and square footages are approximate and subject to change. Illustrations may not represent finished construction details. All optional items indicated are available at additional cost. Not all features available are shown. Please ask our Sales Representative for complete information.



Updated 12.13.22

THE WESTPORT at Hobbs Hole

Floor Plan

3 BEDROOMS, 2 FULL BATHS,
FAMILY ROOM, & COVERED REAR PORCH

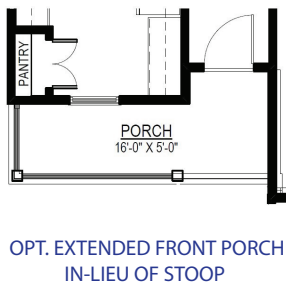
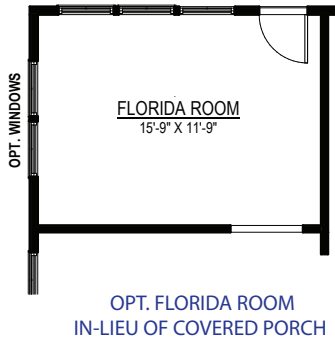

FIRST FLOOR PLAN

Elevations shown are artist's rendering. All plans, details, and square footages are approximate and subject to change. Illustrations may not represent finished construction details. All optional items indicated are available at additional cost. Not all features available are shown. Please ask our Sales Representative for complete information.